

MILANOSESTO



30.06.2017

AREE EX-FALCK
SESTO SAN GIOVANNI

CONCORSO DI PROGETTAZIONE
PER RESIDENZE CONVENZIONATE

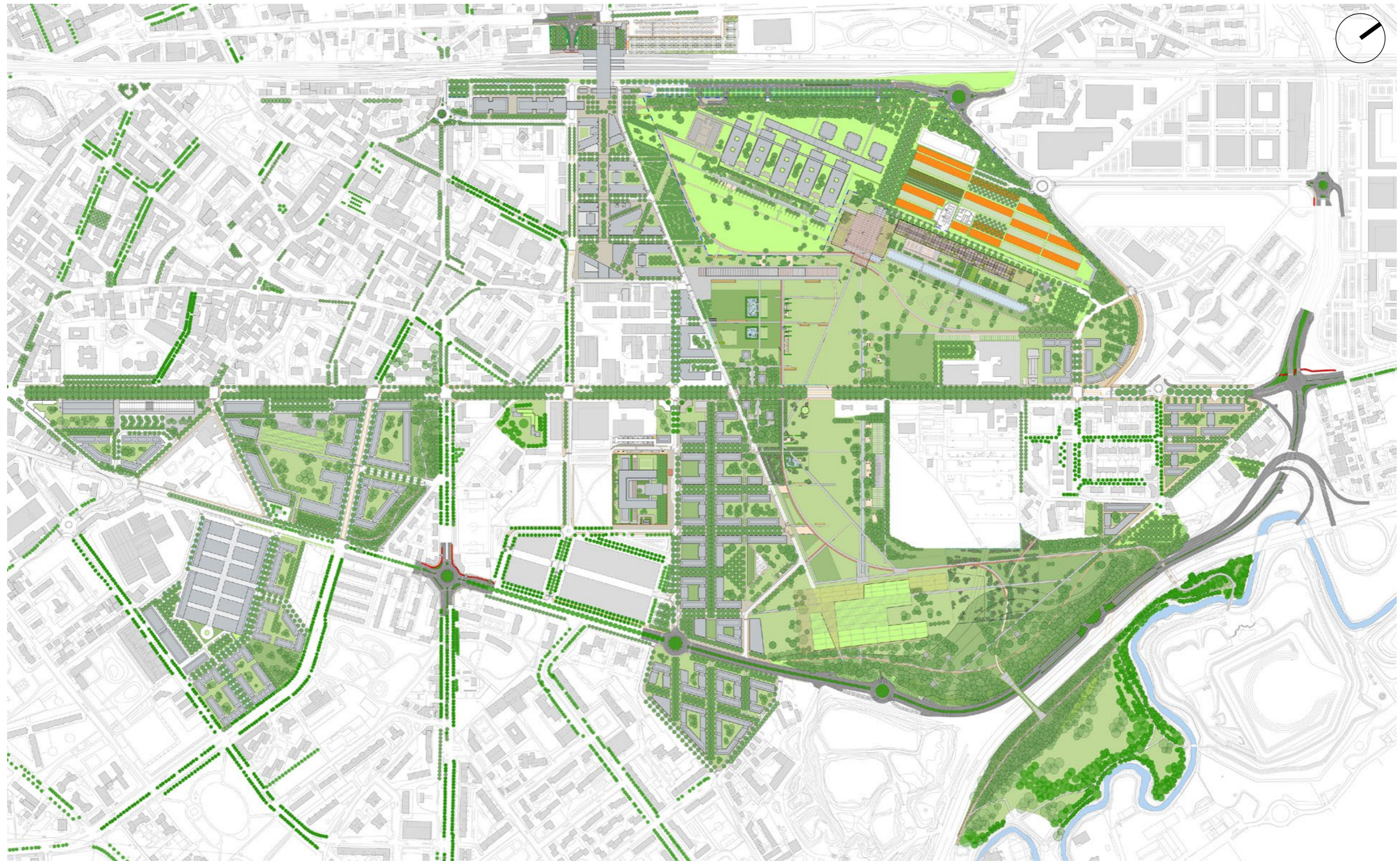

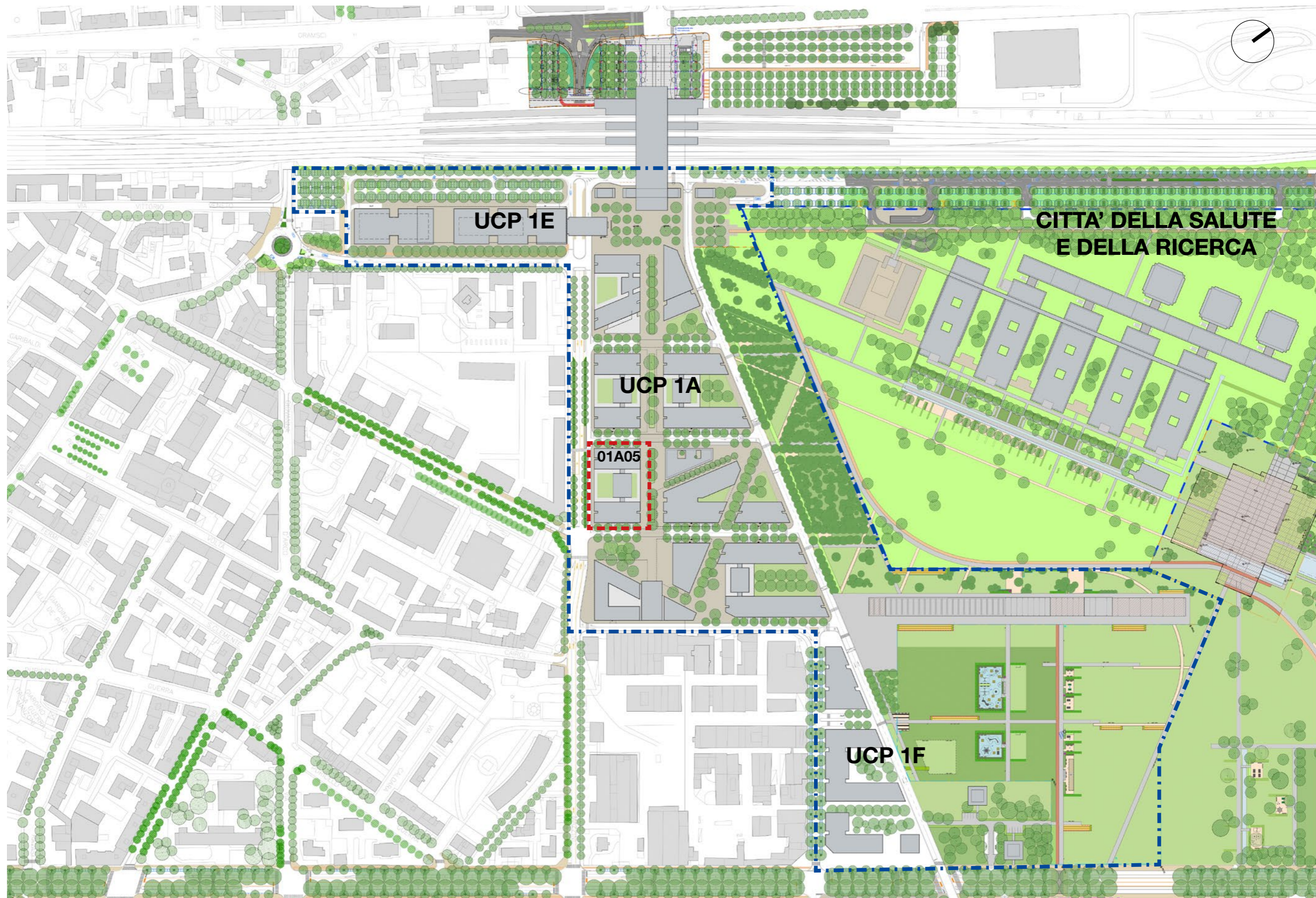

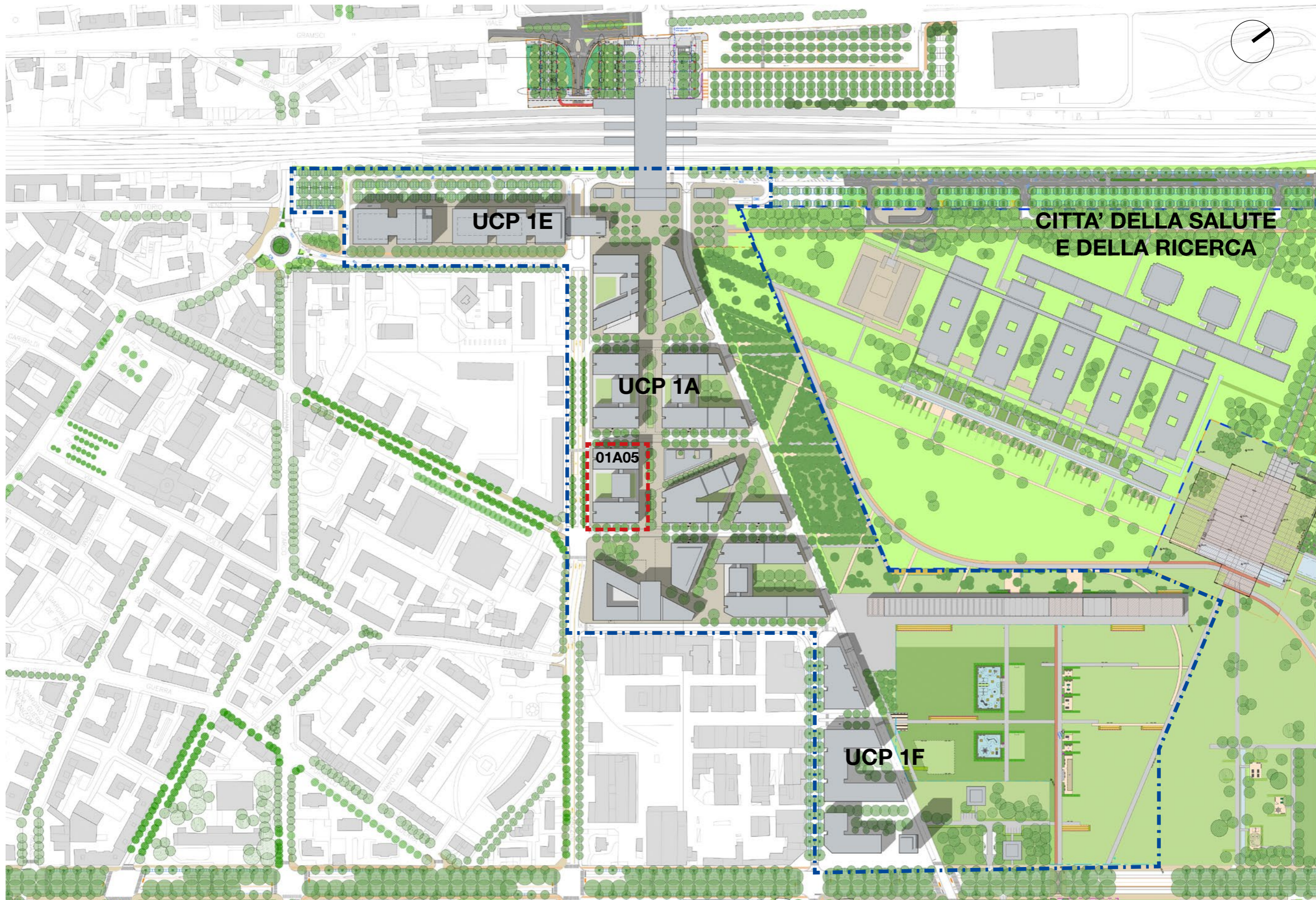



LEGENDA

- Terziario
- Ricettivo
- Edilizia Residenziale Libera
- Edilizia Residenziale Convenzionata
- Commercio
- Servizi al pubblico
- Istruzione



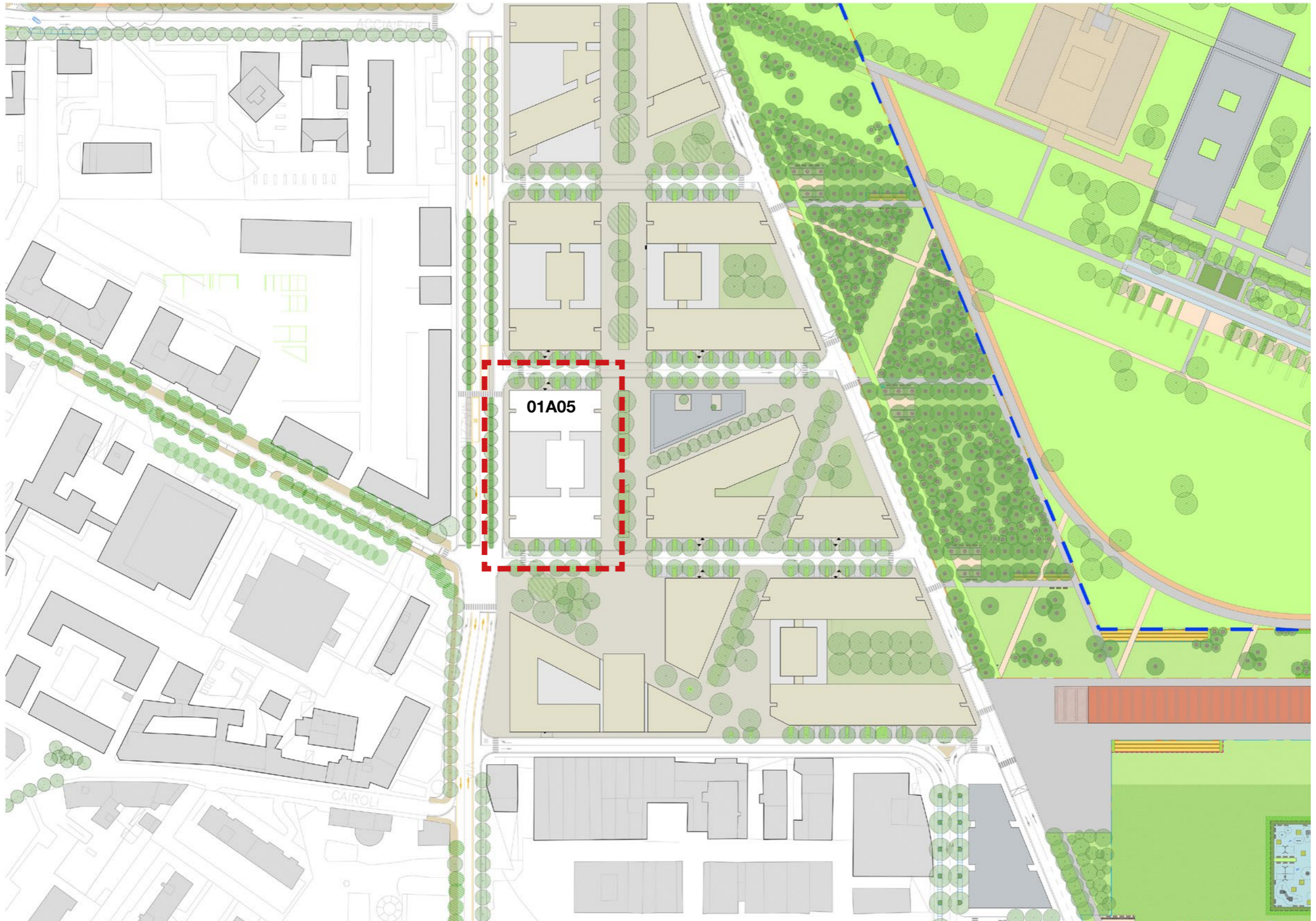

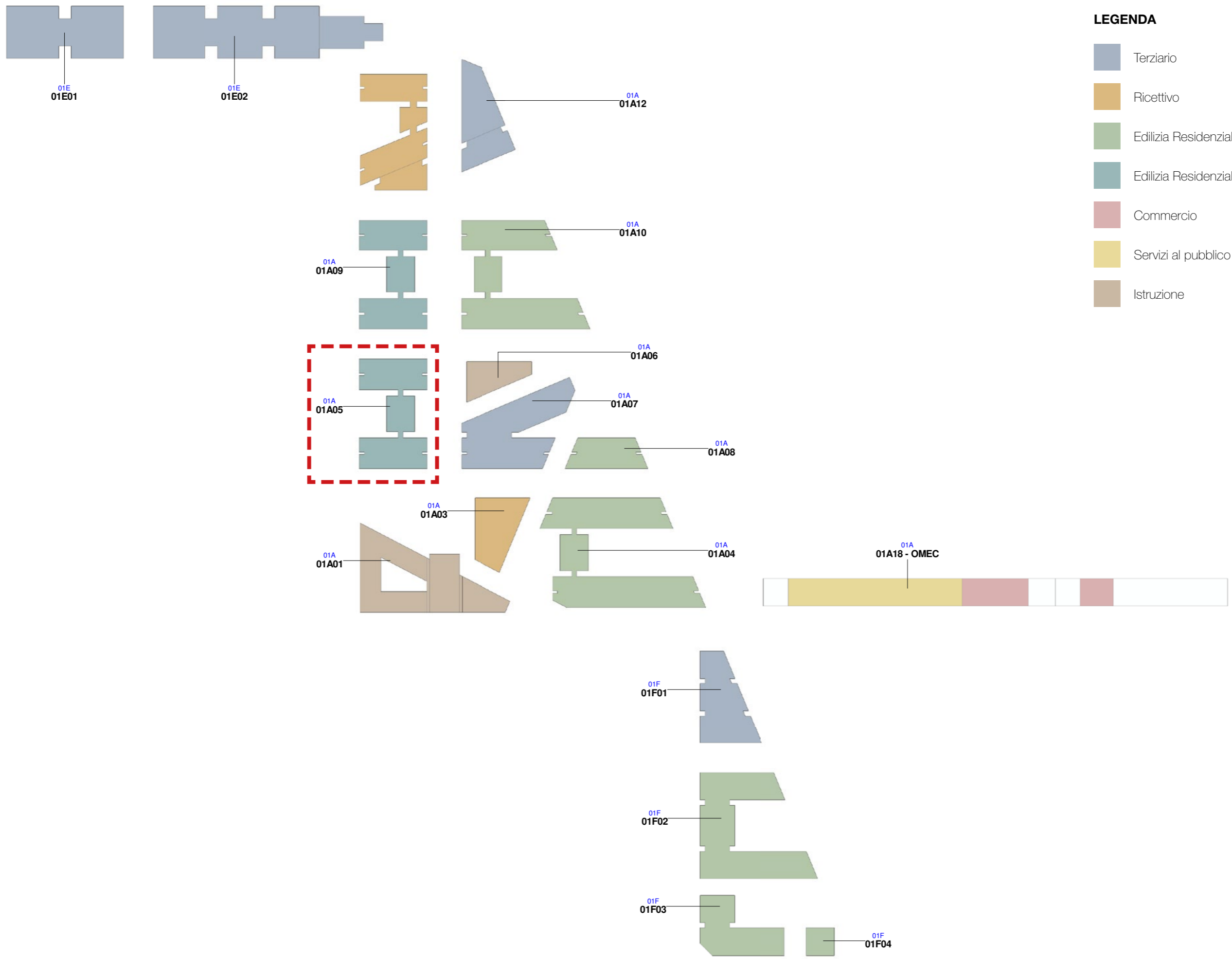

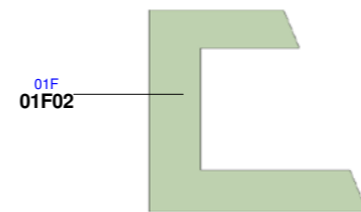
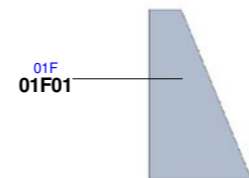
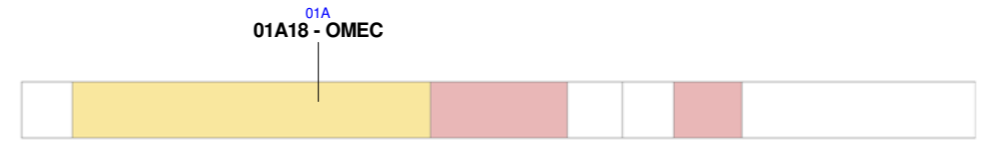
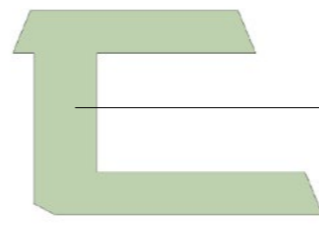
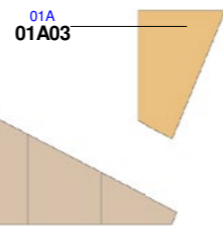
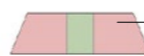
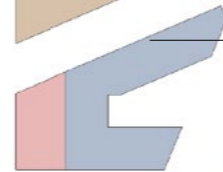
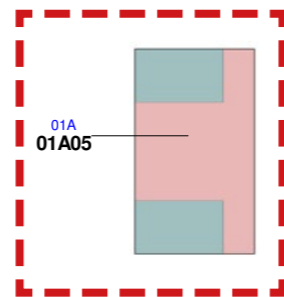
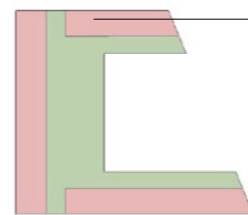
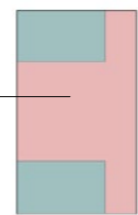
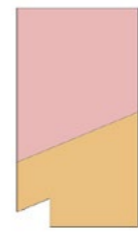
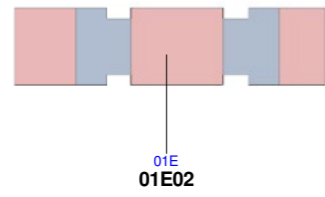
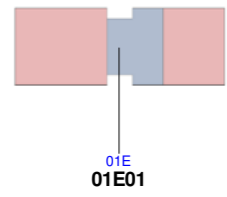

LEGENDA

-  Terziario
-  Ricettivo
-  Edilizia Residenziale Libera
-  Edilizia Residenziale Convenzionata
-  Commercio
-  Servizi al pubblico
-  Istruzione

01A05

Level	Funzione slp	Superficie lorda (mq)
Livello -2	PARK	3.436
Livello -1	PARK	3.436
Totale superficie parcheggi		6.872

Livello 0	ERC	798
Livello 0	C_M	1.305
Livello 1	ERC	1.887
Livello 2	ERC	1.887
Livello 3	ERC	1.887
Livello 4	ERC	1.887
Livello 5	ERC	1.887
Livello 6	ERC	1.887
Livello 7	ERC	1.582
Livello 8	ERC	449

Totale superficie commerciale	1.305
Totale superficie residenziale	14.151

Totale **15.456**

Legenda

PARK	Parcheggio
C_M	Commercio
ERC	Edilizia Residenziale Convenzionata

LEGENDA

	Terziario
	Ricettivo
	Edilizia Residenziale Libera
	Edilizia Residenziale Convenzionata
	Commercio
	Servizi al pubblico
	Istruzione

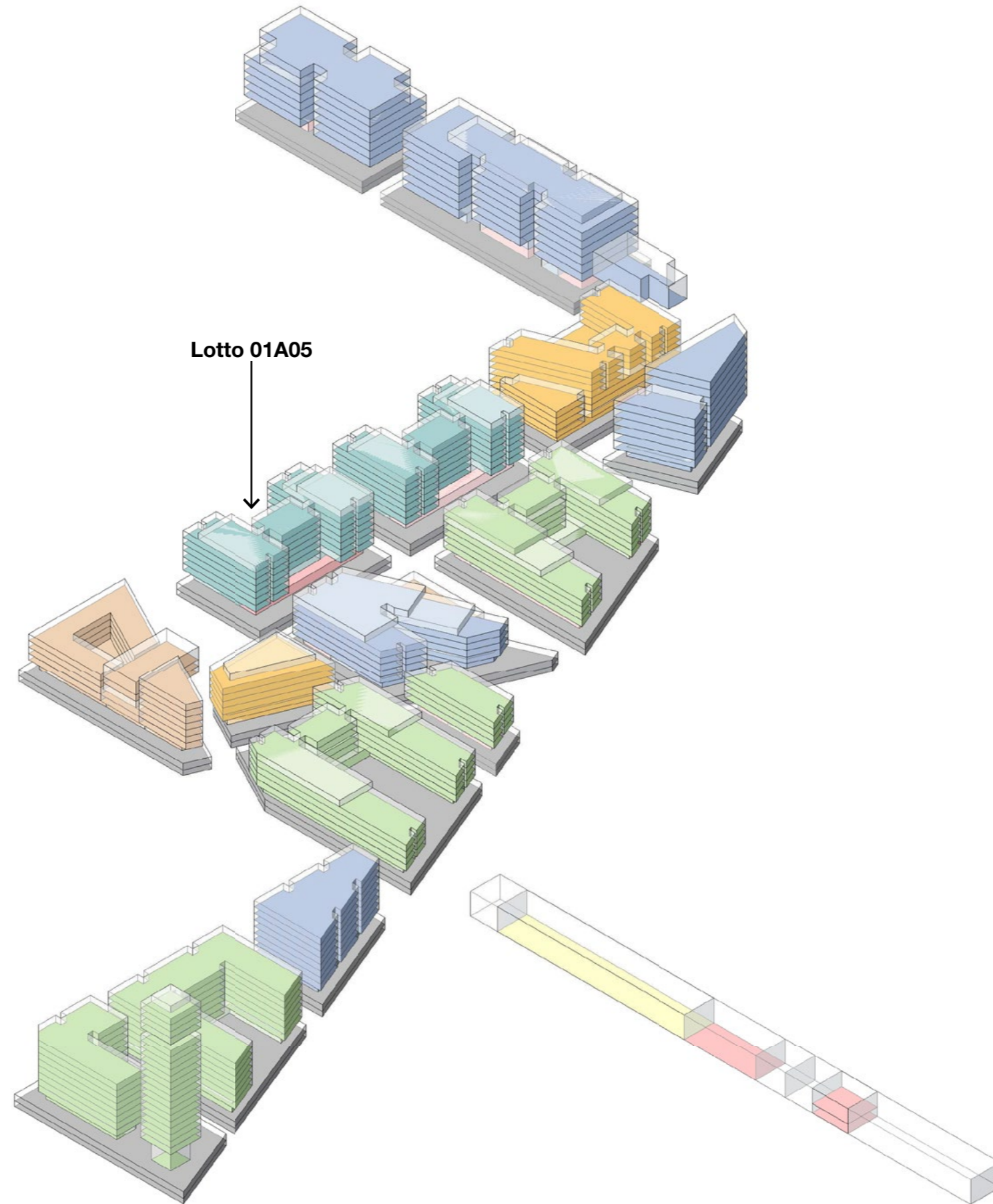

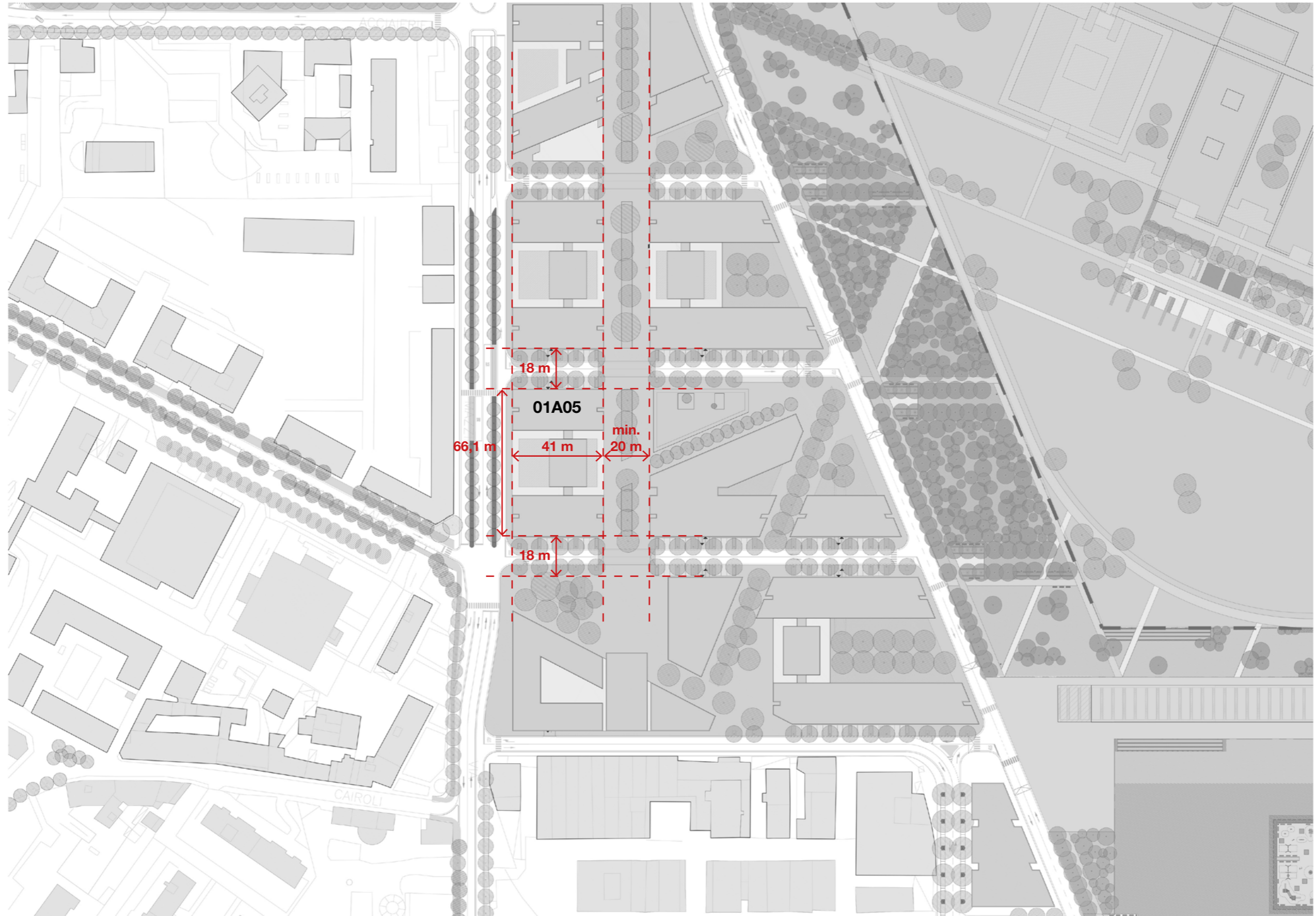
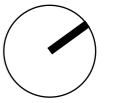

Nota: schema rappresentativo - fare riferimento agli elaborati editabili digitali

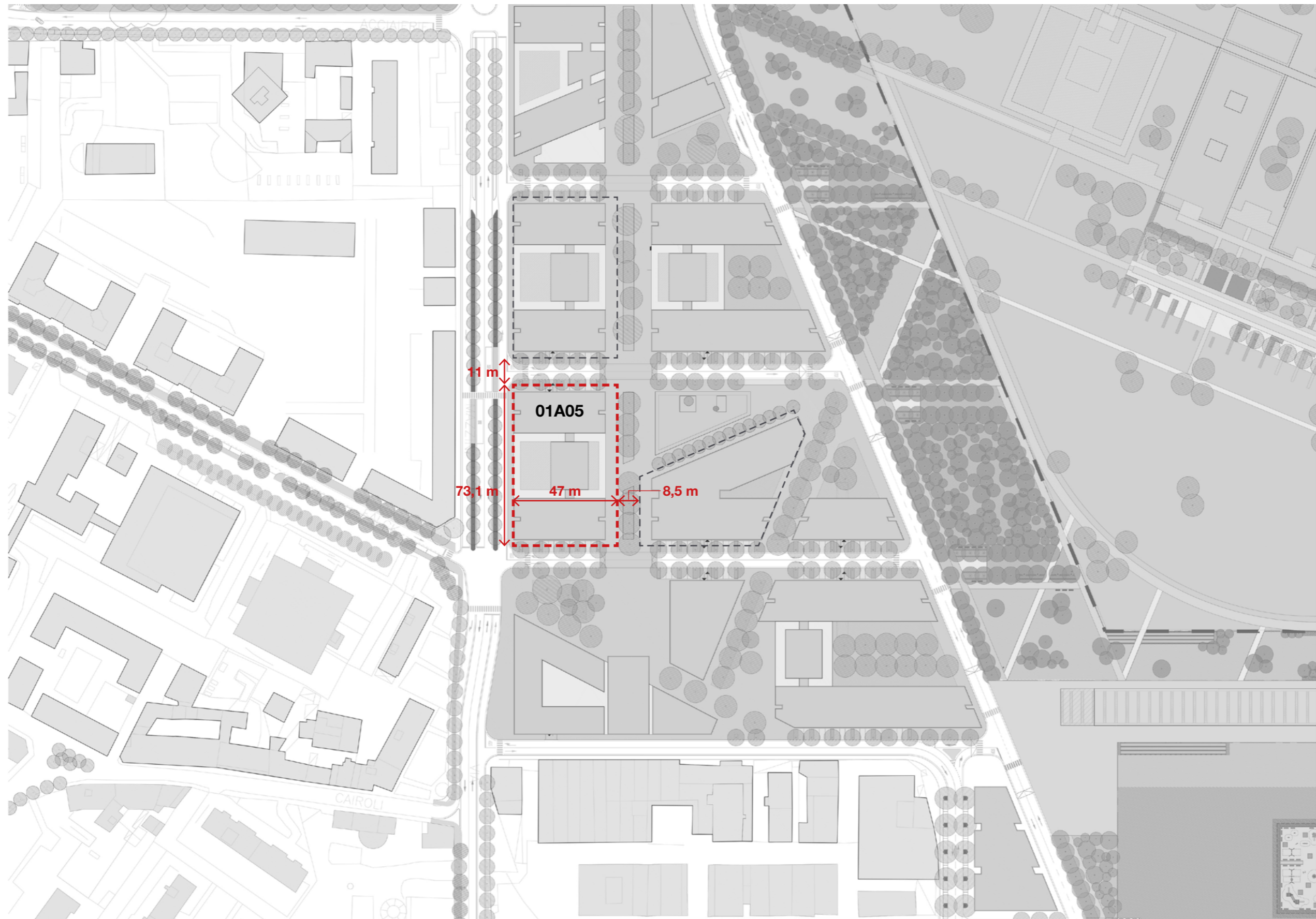

Nota: schema rappresentativo - fare riferimento agli elaborati editabili digitali

Sezione A-A'

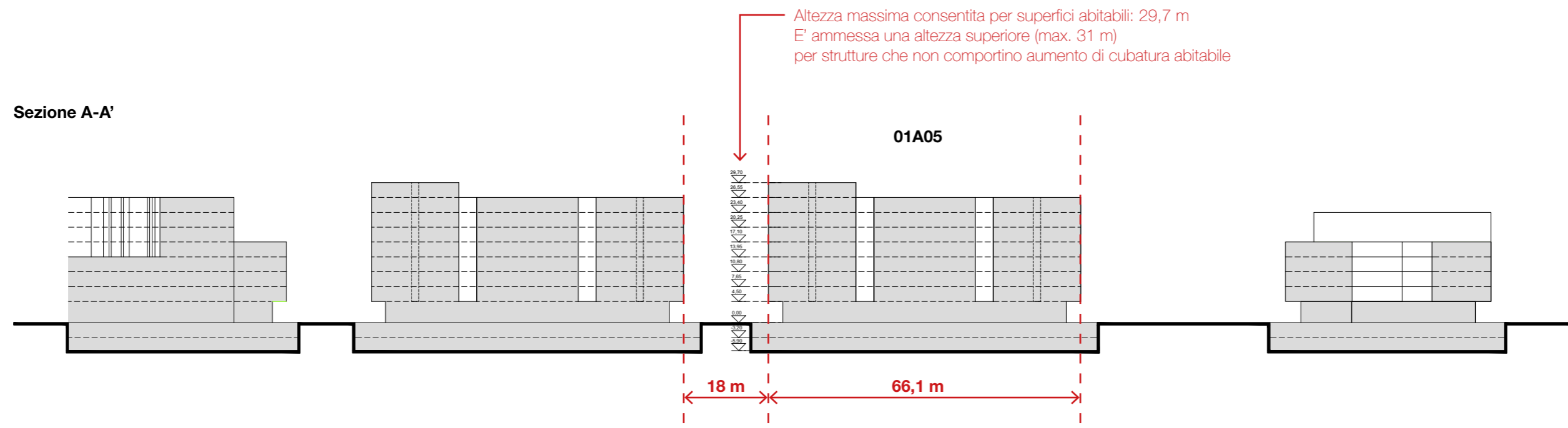

Sezione B-B'

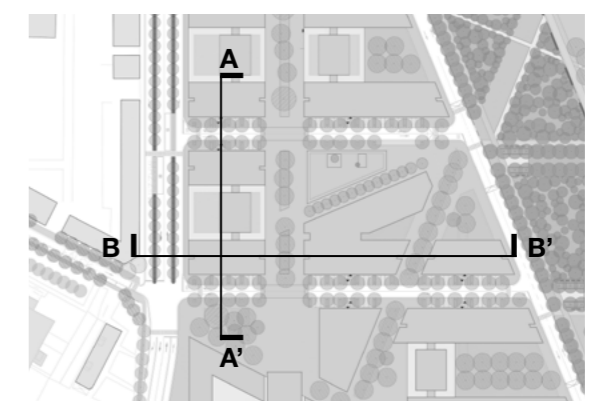
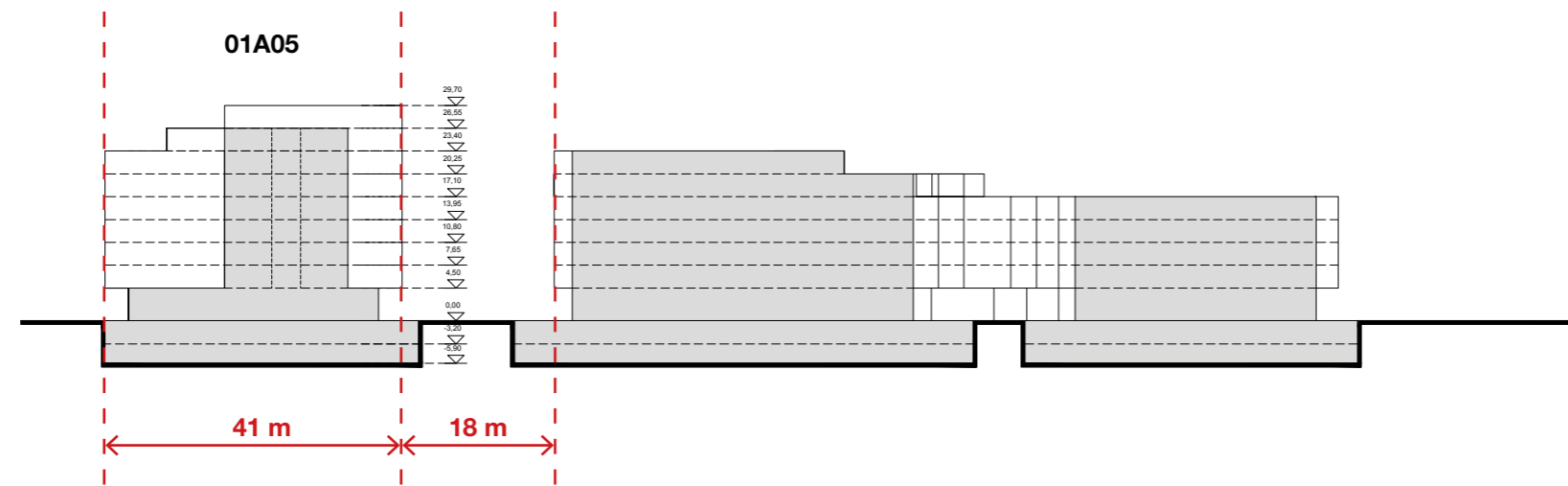

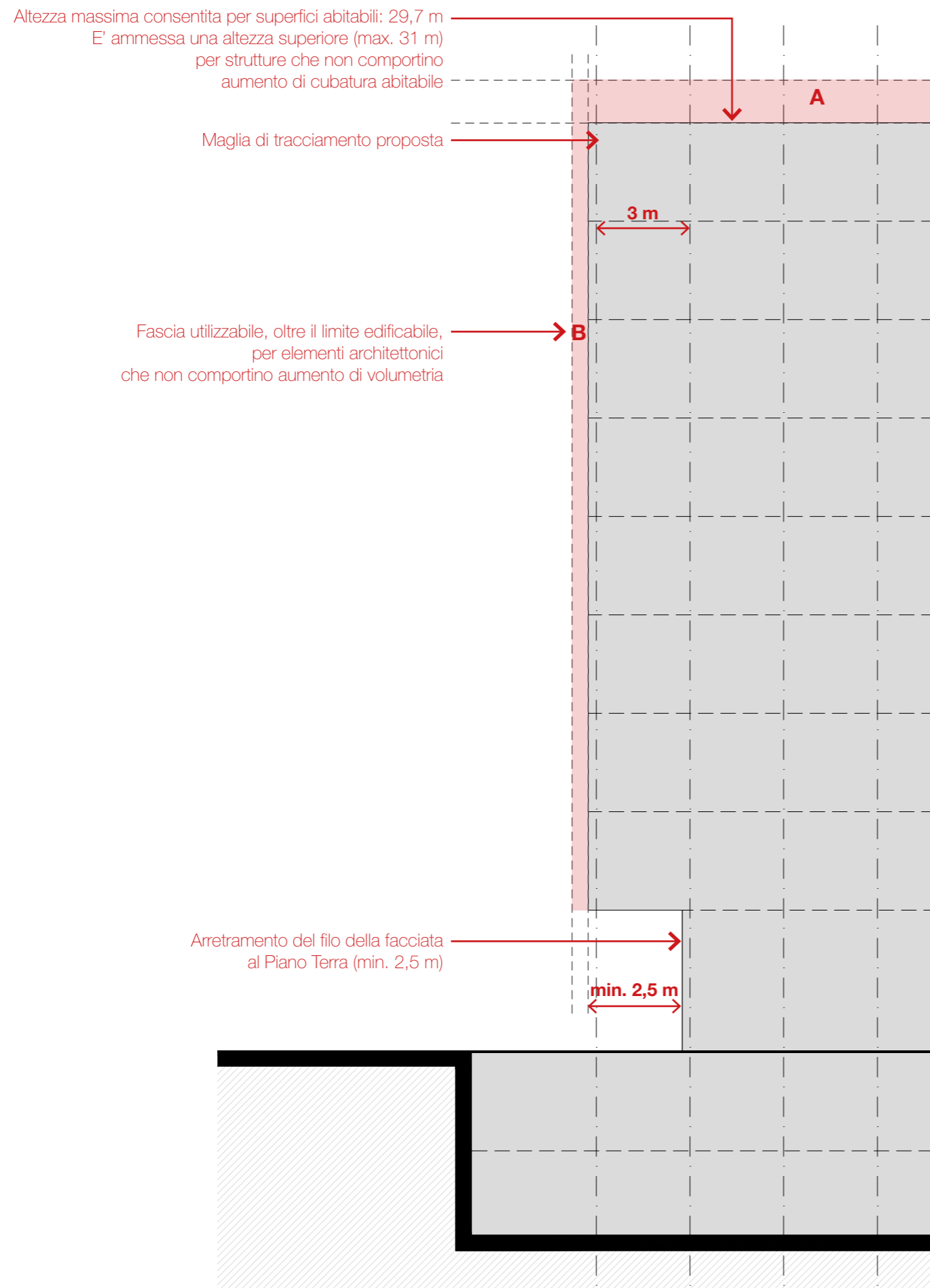

Nota: il passo della maglia di tracciamento è indicativo

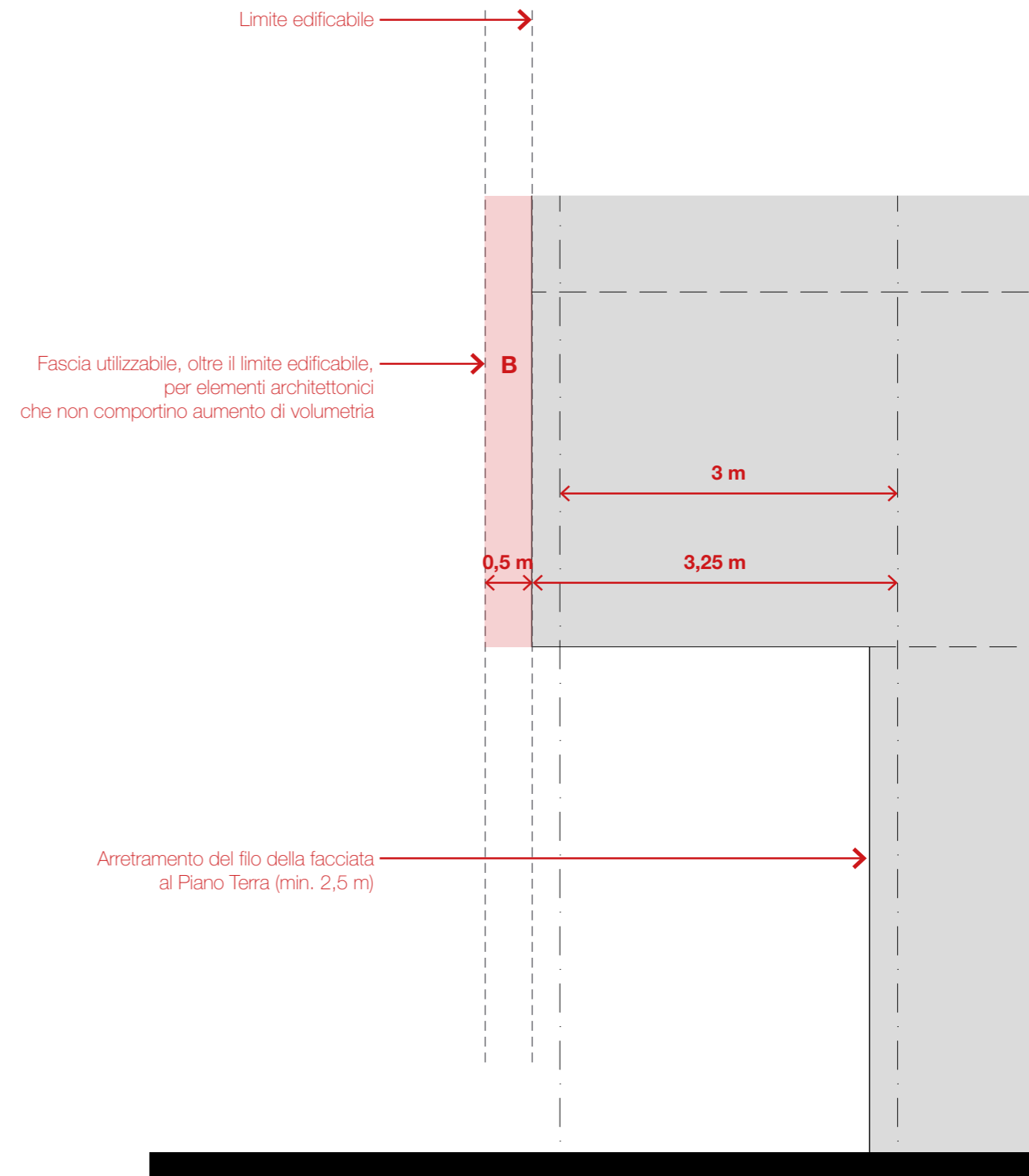

Nota: il passo della maglia di tracciamento è indicativo